

BLOOM™ WINCH



Series 1100HC

HYDRAULIC CABLE WINCHES

The rugged construction and versatility of **Series 1100HC** makes it adaptable to a wide range of applications. **Series 1100HC** winches are equipped with a sliding clutch to allow free-spooling of the drum for industrial pulling and dragging applications including rear of cab and front mounting on ½ to 1½ ton trucks, flat bed trailers, factory material handling, mining and logging operations, air freight pullers, off the road tractors and marine craft.

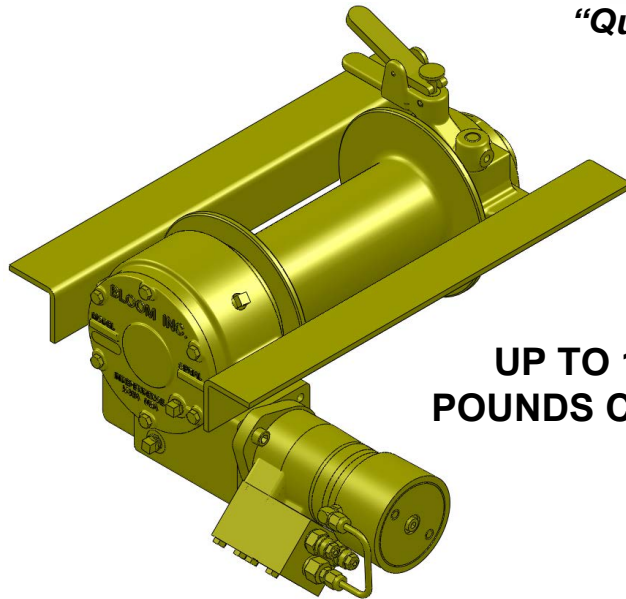

*"Quality Since
1910"*

**UP TO 12,000
POUNDS CAPACITY**

Bloom™ Hydraulic Cable Winches – Standard Features

- | | |
|--------------------|--|
| MOTOR-BRAKE | - DUET-SAFE® Double Action Braking System combines a powerful spring applied, hydraulic released motor-brake with a double counter balance brake valve to automatically hold loads when hydraulic pressure is released and control speed during lowering operations. Winch is ideal for high speed pulling applications or wherever load holding is critical. |
| GEAR CASE | - Made of high strength cast iron. Completely sealed for oil enclosed operation and to keep dirt out. |
| WORM SHAFT | - One piece alloy steel hardened and ground for extra durability. Compact design allows hydraulic motor to be coupled directly to worm. |
| WORM GEAR | - High tensile aluminum-nickel alloy bronze. Optimum lead and pressure angles transmit maximum power to the drum. |
| GEAR RATIO | - 20:1 standard, 10:1, 27:1, 40:1 optional ratios provide optimum efficiency in power and speed. |
| BEARINGS | - Worm gear and worm shaft run on tapered roller bearings. Outer end housing has sealed ball bearing. |
| DRUM SHAFT | - 1-1/2" diameter heat -treated alloy steel minimum tensile strength 150,000 psi. |
| CABLE DRUM | - Tough all steel construction resists breakage or warping. |
| CLUTCH | - Series 1100HC winches comes equipped with heat-treated dog type clutch to provide free-spooling of the winch drum. Positive lock-in and lock-out. |



www.bloommfg.com

BLOOM

Manufacturing Inc.

Winch Division

"Custom Engineered Solutions"

**Lifting
Pulling
Hoisting**

Toll Free Number: 1-800-394-1139

1443 220th Street,, Independence, Iowa 50644 • FAX: 319-827-1140 • PHONE: 319-827-1139

BLOOM™ WINCH



Series 1100HC

Model Selection from Performance Data

*"Quality Since
1910"*

MODEL EXAMPLE: 11H-3.0T-L8-C-10

Gear Case Mounting

11H = Series 1100HC With 1-1/2" Drum Shaft

Hydraulic Motor Designation

3.0T, 4.0T, 6.2T, 9.6T

Gear Ratio

10:1, 20:1, 27:1, 40:1

Drum Sizes

S8, L8 & XL10

Clutch

Designation

(Do not use clutch model for
lifting Applications)

DRUM CAPACITY

CABLE DIAMETER (IN.)	1/4	5/16	3/8	7/16	1/2
DRUM "S8" CAPACITY (FT.)	260	160	105	75	55
DRUM "L8" CAPACITY (FT.)	390	240	160	110	80
DRUM "XL10" CAPACITY (FT.)	840	550	340	250	170

Special Note.

Series 1100HC winches are available only in low profile mounting - the "LP" designation is not required. However, it is necessary on all low profile winches to specify whether the winch is to be supplied "with angles" or "less angles".

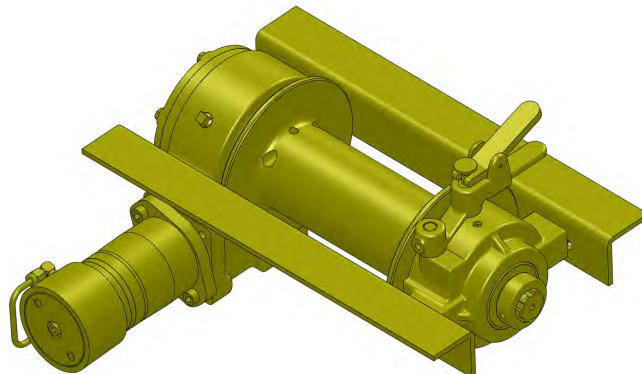

BLOOM™ WINCH



Series 1100HC

Bloom Hydraulic Cable Winches Model Selection from Performance Data

"Quality Since
1910"

10:1 RATIO (optional)

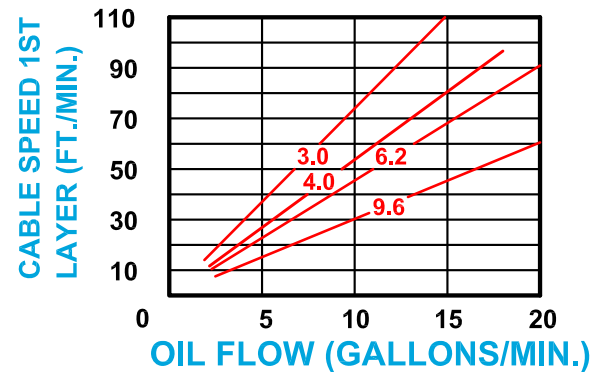
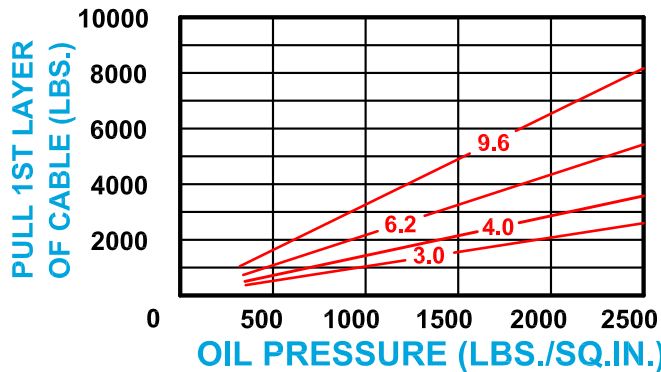

20:1 RATIO (standard)

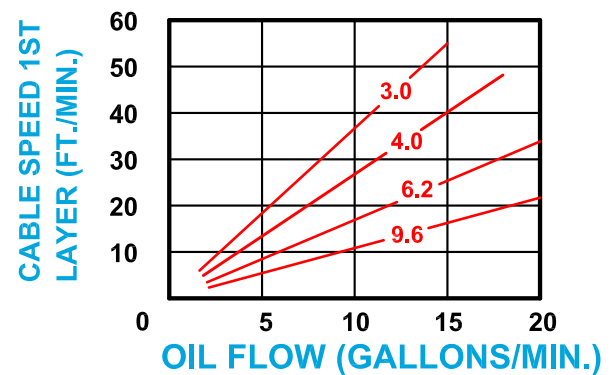
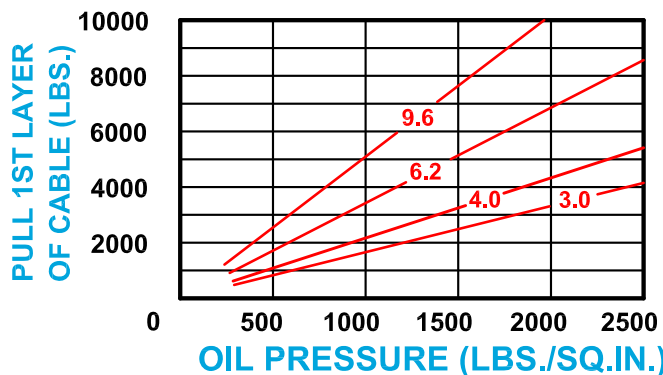

27:1 RATIO (optional)

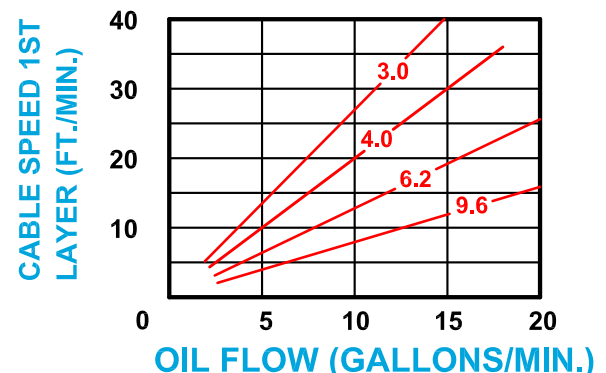
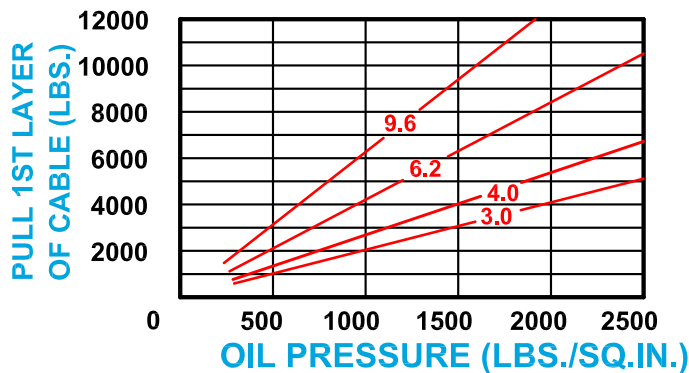

40:1 RATIO (optional)

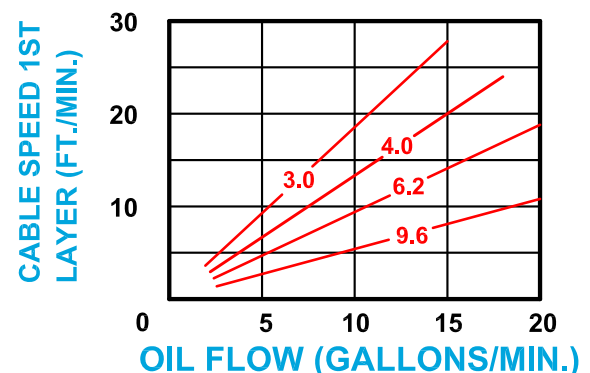
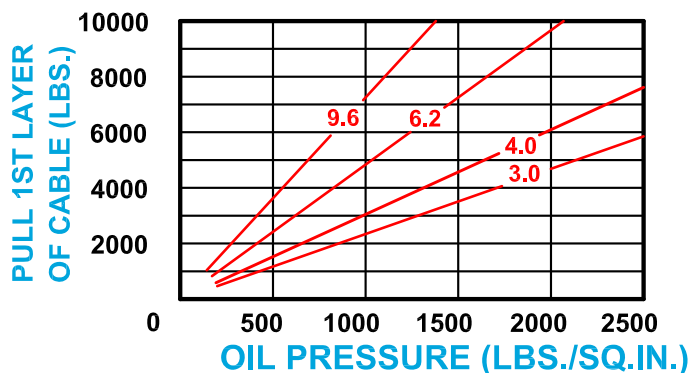



"Quality Since
1910"

BLOOM™ WINCH

Dimensional Drawings

Series 1100<7 K JH 'S8 and L8 Drum
Low Profile Model - 7`i HW 'Drive

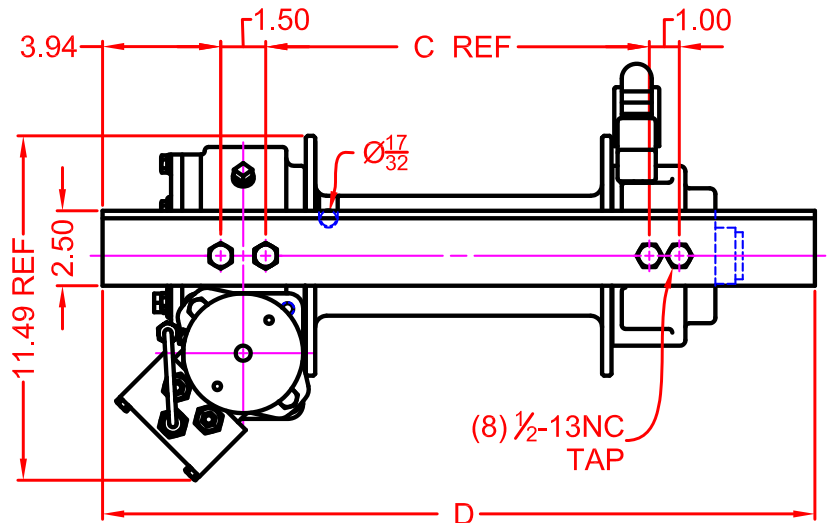
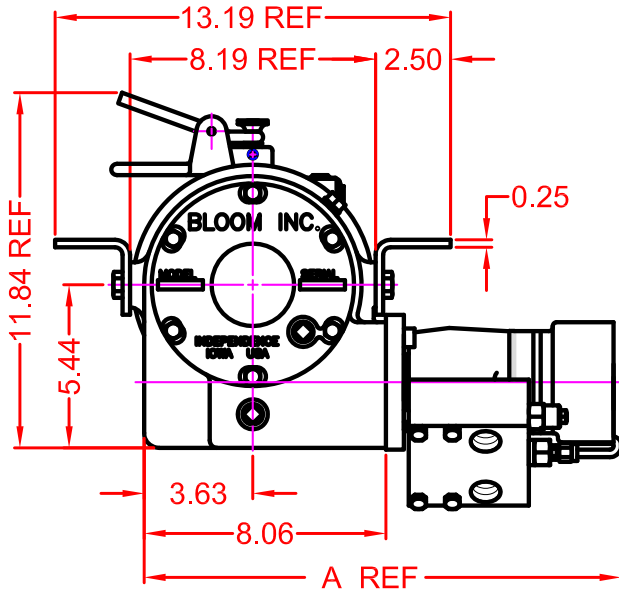
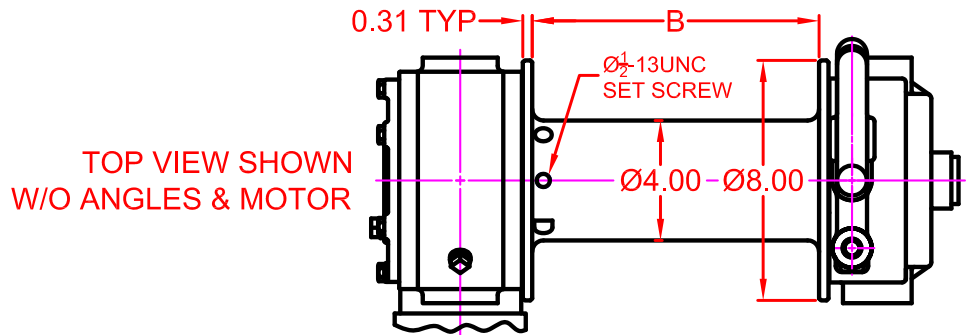

MOTOR DESIGNATION	3.0	4.0	6.2	9.6
Ⓐ DIMENSION	15.91	16.03	16.28	16.53

DRUM DESIGNATION	WINCH DIMENSION		
	B	C	D
S8C	6.56	9.79	20.75
L8C	9.56	12.79	23.75



"Quality Since
1910"

BLOOM™ WINCH

Dimensional Drawings

Series 1100<7 K JH 'L @ \$ Drum
Low Profile Model - 7`i HW 'Drive

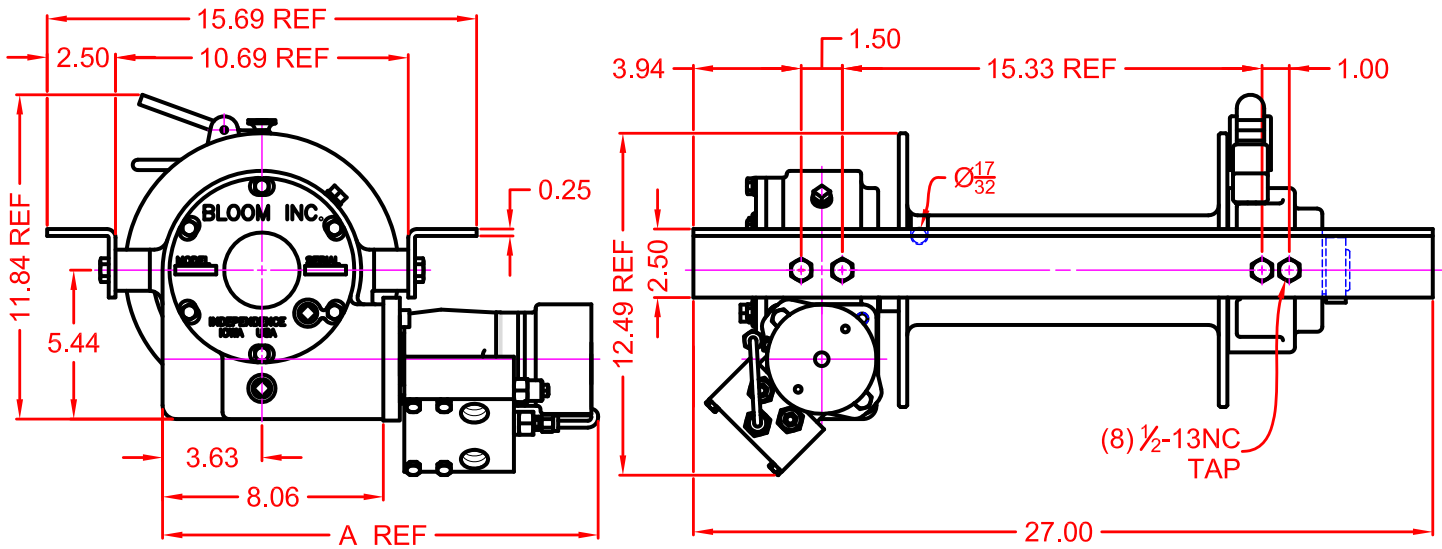
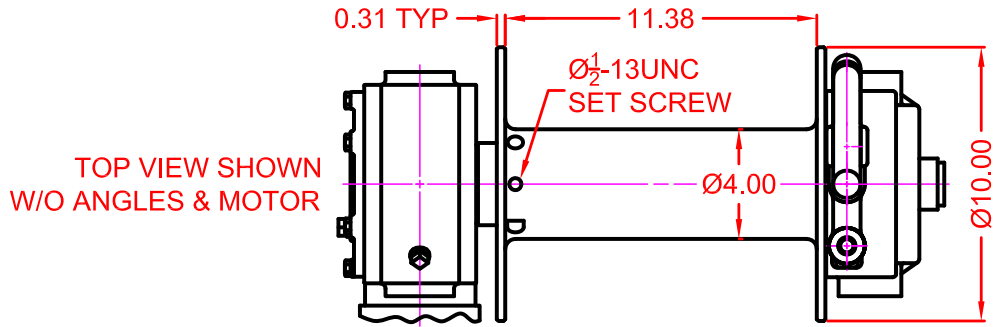

MOTOR DESIGNATION	3.0	4.0	6.2	9.6
(A) DIMENSION	15.91	16.03	16.28	16.53

CABLE DIAMETER (IN.)	1/4	5/16	3/8	7/16	1/2
DRUM "XL10" CAPACITY (FT.)	840	550	340	250	170

BLOOM™ WINCH

1100HC Series Model Selection

3.0T MOTOR

11H-3.0T-S8C
11H-3.0T-L8C
11H-3.0T-XL10C
11H-3.0T-XL12C
11H-3.0T-XL14C

6.2T MOTOR

11H-6.2T-S8C
11H-6.2T-L8C
11H-6.2T-XL10C
11H-6.2T-XL12C
11H-6.2T-XL14C

9.6T MOTOR

11H-9.6T-S8C
11H-9.6T-L8C
11H-9.6T-XL10C
11H-9.6T-XL12C
11H-9.6T-XL14C

BLOOM™ WINCH

Correct choice of Directional Control Valves for Bloom Winches

Winches require a **Motor Spool Control Valve**.
That is the valve's work ports are **open** to tank in neutral position.

*Winches require ridged mounting plate.
See owner's manual for information about proper mounting plate thickness or call Bloom Sales Engineer at factory.

WARNING!

Goods are not intended for use in the moving or lifting of persons!

The winches described herein are neither designed nor intended for use or application to equipment used in the lifting or moving of persons and it is understood that all such use shall be at the sole risk of the user.

The cable clamps on winches are not designed to hold rated loads. A minimum of 5 wraps of cable must be left on drum barrel to guarantee holding of rated load.

Applications of winch where life would be endangered by any event are not recommended.



BLOOM Manufacturing Inc. **Winch Division**

1443 220th Street,, Independence, Iowa 50644

FAX 319-827-1140 PHONE 319-827-1139

www.bloommfg.com

©Copyright 2015 Bloom Mfg. Inc.