

BLOOM™ WINCH



Series 2000H

Hydraulic Speed Reducer

*“Quality Since
1910”*

The rugged construction and versatility of the **2000H Series Speed Reducer** is ideal for stationary & mobile applications where high speed, high torque, or variable speed and reversing are needed. Applications include paving and curb forming, ditching, irrigation and plastic and extruding equipment.



**Powerful – Compact
Efficient**

Up To 24,000
In.-lbs. Output

Bloom™ Hydraulic Speed Reducers – Standard Features

- MOTOR-BRAKE** - **DUET-SAFE® Double Action Braking System** combines a powerful spring applied, hydraulic released motor-brake with a double counter balance brake valve to automatically hold loads when hydraulic pressure is released and control speed during lowering operations. Speed Reducer is ideal for high speed lifting and pulling applications or wherever load holding is critical.
- GEAR CASE** - Made of high strength steel. Completely sealed for oil enclosed operation and to keep dirt out.
- PLANETARY GEAR** - High Efficiency Double Reduction – Rugged – Built to Last.
- GEAR RATIO** - 17:1 Standard.
- BEARINGS** - Shaft is supported by two heavy duty oil lubricated bearings in gear case.
- OUTPUT SHAFT** - 1-1/2” diameter heat -treated alloy steel minimum tensile strength 150,000 psi.



BLOOM

Manufacturing Inc.

Winch Division

*Lifting
Pulling
Hoisting*

Toll Free Number: 1-800-394-1139

www.bloommfg.com

“Custom Engineered Solutions”

1443 220th Street,, Independence, Iowa 50644 • FAX: 319-827-1140 • PHONE: 319-827-1139



2000H Series Speed Reducer Model Selection from Performance Data

MODEL EXAMPLE: 20H-3.0T-SR-17

Gear Case and
Shaft Designation

20H = 2000H Series with 1-1/2" Output Shaft only

Hydraulic Motor Designation
3.0T, 6.2T

Speed Reducer

Gear Ratio
17:1

(20H) Indicates speed reducer series. "20H" indicates a 2000H Series with 1-1/2" output shaft. Models are available up to 24,000 in.-lbs. output torque.

(3.0T) Designates hydraulic motor. Motor size is determined from motor performance charts.

(SR) Indicates planetary speed reducer.

(17) Indicates gear ratio. 17:1 is standard.

BLOOM™ WINCH



2000H Series Speed Reducer

"Quality Since 1910"

With Hydraulic Fail-safe Brake

Model Selection from Performance Data

17:1 RATIO

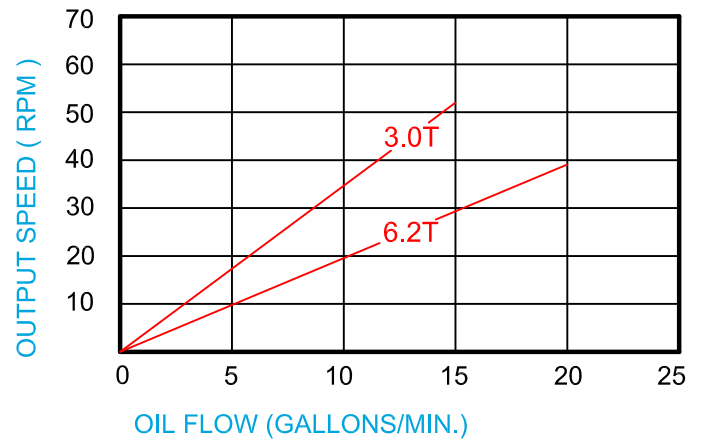
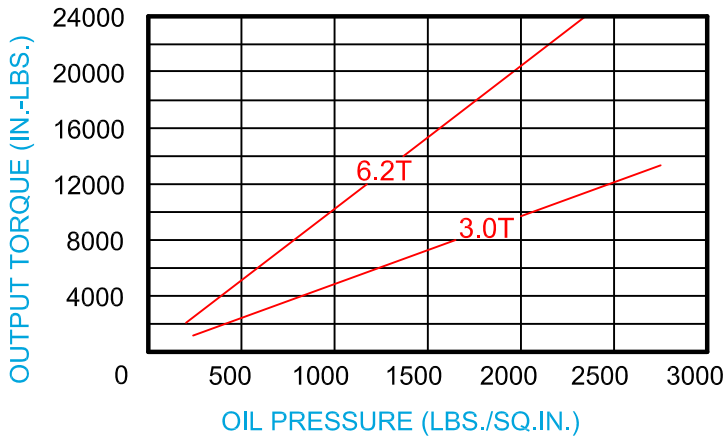

BLOOM™ WINCH

Dimensional Drawings

2000H Series Speed Reducer



"Quality Since 1910"

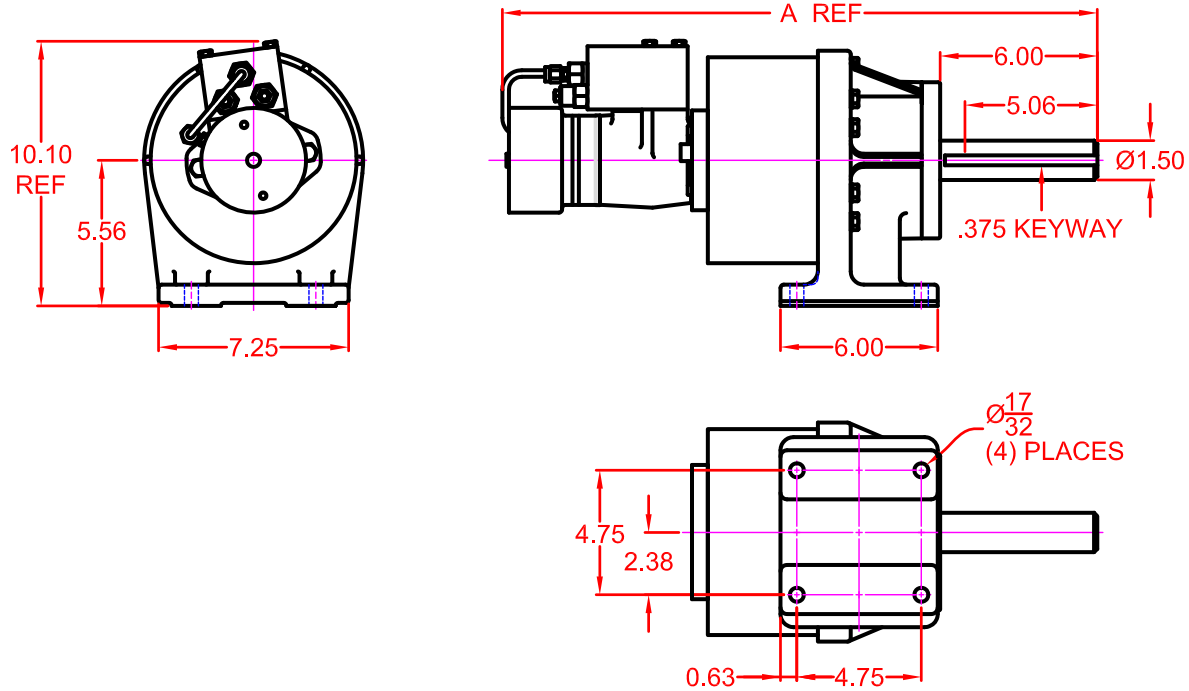

	MOTOR DESIGNATION	
	3.0T	6.2T
A DIMENSION	22.70	23.08

BLOOM™ WINCH



*"Quality Since
1910"*

Motor Spool Valve - Work Ports are **open** to tank in neutral position
Use on all speed reducers that use Counter-Balance Valves to hold load.

*Speed Reducers require ridged mounting plate.
See owner's manual for information about proper mounting
plate thickness or call Bloom Sales Engineer at factory

WARNING!

Goods are not intended for use in the moving or lifting of persons!

The winches described herein are neither designed nor intended for use or application to equipment used in the lifting or moving of persons and it is understood that all such use shall be at the sole risk of the user.

The cable clamps on winches are not designed to hold rated loads. A minimum of 5 wraps of cable must be left on drum barrel to guarantee holding of rated load.

Applications of winch where life would be endangered by any event are not recommended.



BLOOM Manufacturing Inc. **Winch Division**

1443 220th Street,, Independence, Iowa 50644

FAX 319-827-1140 PHONE 319-827-1139

www.bloommfg.com

© Copyright 2010 Bloom Mfg. Inc.

RV7/2001