

# Series 1000HC

## **HYDRAULIC CABLE WINCHES**



*"Quality Since  
1910"*

The rugged construction and versatility of the **1000HC Series** makes it adaptable to a wide range of applications. The **1000HC Series** winches are equipped with a sliding clutch to allow free-spooling of the drum for industrial pulling applications including rear of cab and front mounting on ½ to 1 ½ ton trucks, flat bed trailers, material handling, mining and logging operations, air freight pullers, off road tractors, aboard ships and boats. 1000HC Series may be ordered galvanized.



1000HC Series shown with  
Automatic Hydraulic Motor  
Safety Brake

**UP TO 12,000 LBS.  
CAPACITY**

### Bloom Hydraulic Cable Winches – Standard Features

- |                    |   |
|--------------------|---|
| <b>MOTOR BRAKE</b> | - Spring applied hydraulic release motor brake automatically holds load when hydraulic pressure is released. Utilizes a Double counter balance valve making it ideal for high speed Pulling Applications. |
| <b>GEAR CASE</b>   | - Made of high strength cast iron. Completely sealed for oil enclosed operation and to keep dirt out.   |
| <b>WORM SHAFT</b>  | - One piece alloy steel hardened and ground for extra durability. Compact design allows hydraulic motor to be coupled directly to worm.   |
| <b>WORM GEAR</b>   | - High tensile aluminum-nickel alloy bronze. Optimum lead and pressure angles transmit maximum power to the drum.   |
| <b>GEAR RATIO</b>  | - 20:1 standard, 10:1, 27:1, 40:1 optional ratios provide optimum efficiency in power and speed.  |
| <b>BEARINGS</b>    | - Worm gear and worm shaft run on tapered roller bearings. Outer end housing has sealed ball bearing.   |
| <b>DRUM SHAFT</b>  | - 1-1/2" diameter heat -treated alloy steel minimum tensile strength 150,000 psi.   |
| <b>CABLE DRUM</b>  | - Tough all steel construction resists breakage or warping.   |
| <b>CLUTCH</b>      | - 1000HC Series winches comes equipped with heat-treated dog type clutch to provide free-spooling of the winch drum. Positive lock-in and lock-out.   |



[www.bloommfg.com](http://www.bloommfg.com)

# **BLOOM**

**Manufacturing Inc.**

Winch Division

**"Custom Engineered Solutions"**

*Lifting  
Pulling  
Hoisting*

Toll Free Number: 1-800-394-1139

1443 220<sup>th</sup> Street,, Independence, Iowa 50644 • FAX: 319-827-1140 • PHONE: 319-827-1139

# 1000HC Series

## Model Selection from Performance Data



"Quality Since  
1910"

MODEL EXAMPLE: 10H-3.0T-L8-C-10-LP

Gear Case Mounting

10H = 1000HC Series With 1-1/2" Drum Shaft

Low Profile Mounting  
(specify with or without  
mounting angles)

Hydraulic Motor Designation

3.0T, 6.2T, 9.6T

Gear Ratios

10:1, 20:1, 27:1, 40:1

Drum Sizes

S8, L8, XL10, XL12, XL14

Clutch

Designation

(Do not use clutch model for  
lifting Applications)

(10H) Indicates winch series. "10H" indicates a 1000HC Series winch with an 1-1/2" drum shaft.. The "H" indicates spring applied hydraulic release motor brake.

(3.0T) Designates hydraulic motor. Motor size is determined from motor performance charts. All motors come with spring applied hydraulic release motor brake.

(L8) elect drum size from chart below:

## DRUM CAPACITY

| CABLE DIAMETER (IN.)       | 1/4  | 5/16 | 3/8 | 7/16 | 1/2 |
|----------------------------|------|------|-----|------|-----|
| DRUM "S8" CAPACITY (FT.)   | 260  | 160  | 105 | 75   | 55  |
| DRUM "L8" CAPACITY (FT.)   | 390  | 240  | 160 | 110  | 80  |
| DRUM "XL10" CAPACITY (FT.) | 840  | 550  | 340 | 250  | 170 |
| DRUM "XL12" CAPACITY (FT.) | 1320 | 840  | 580 | 380  | 280 |
| DRUM "XL14" CAPACITY (FT.) | 1900 | 1180 | 760 | 540  | 410 |

(C) Designates 1000HC Series winch with dog type clutch for free - spooling drum.

(10) Indicates gear ratio. 10:1 is standard. 20:1, 27:1, and 40:1 are also available.

(LP) Design low profile mounting on 1000HC Series winches. 1000HC Low Profile Series winches with mounting angles are available only with S8 and L8 drums. However, it is necessary on all low profile whether the winch is to be supplied "with angles" or "less angles".



*"Quality Since 1910"*

# 1000H Series Model Selection from Performance Data

## 10:1 RATIO (optional)

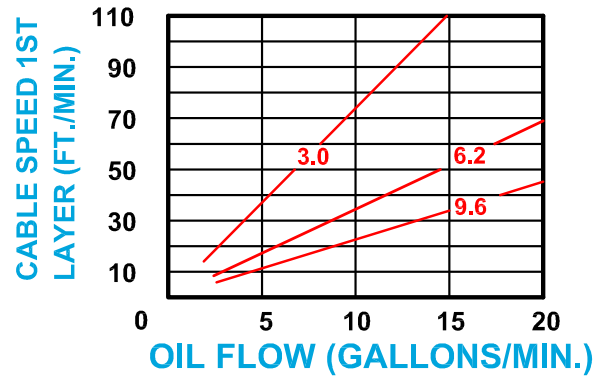
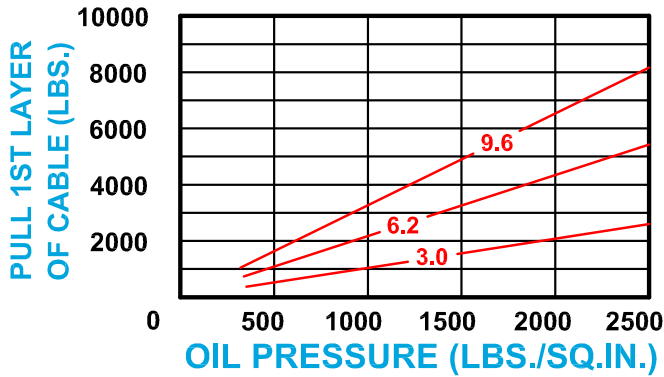

## 20:1 RATIO (standard)

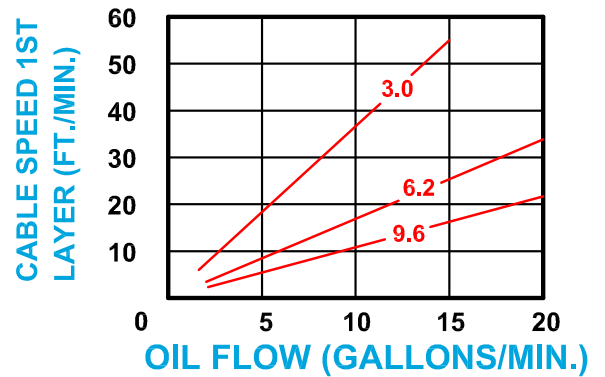
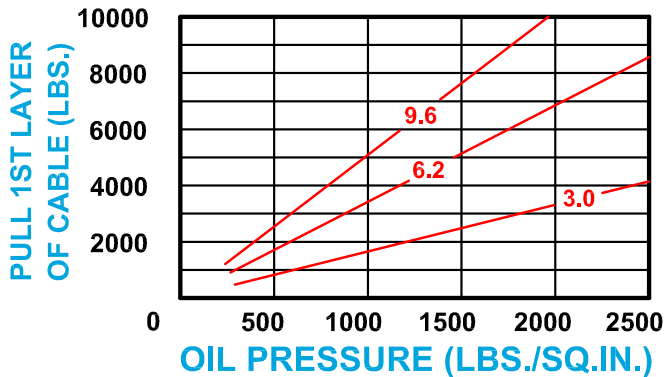

## 27:1 RATIO (optional)

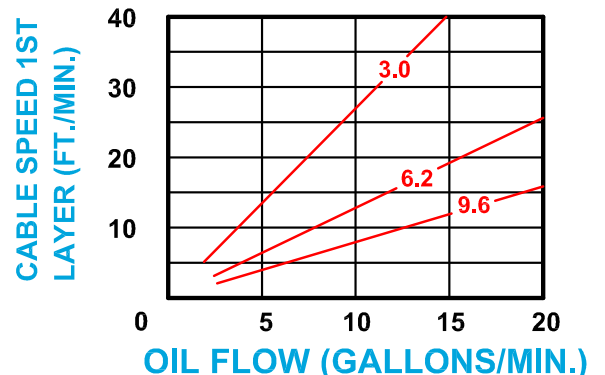
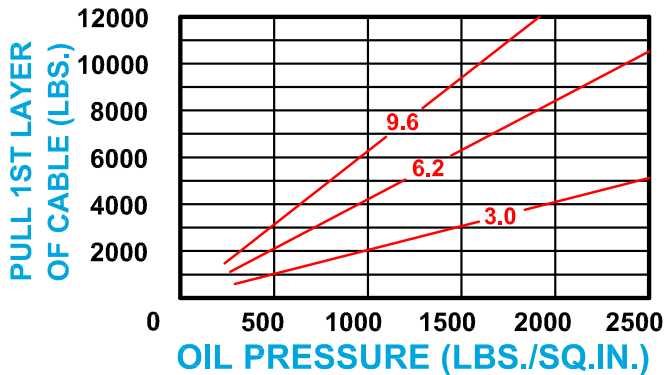

## 40:1 RATIO (optional)

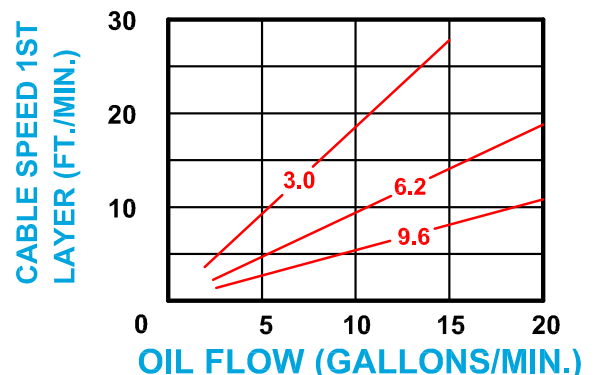
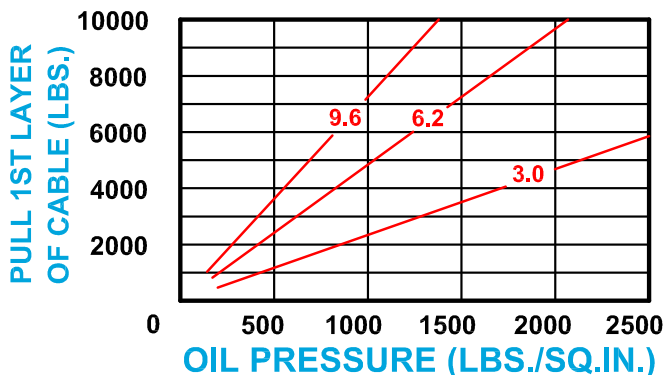



**"Quality Since  
1910"**

# Dimensional Drawings

**1000H Series With S8 and L8 Drum  
Base Mount Model - Clutch Drive**

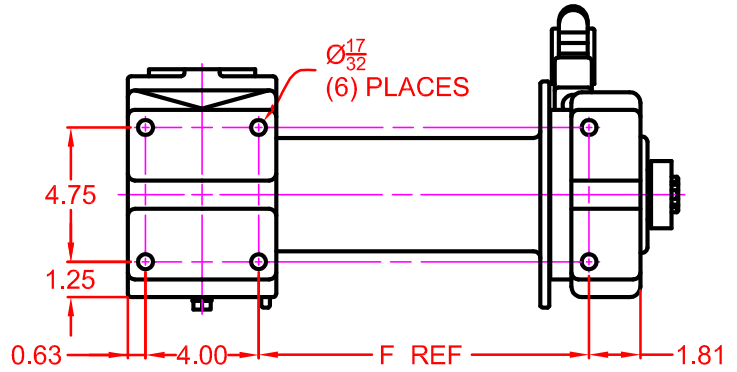
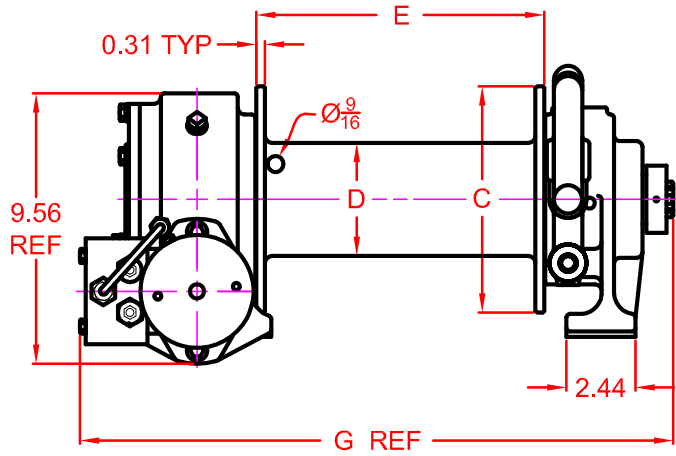
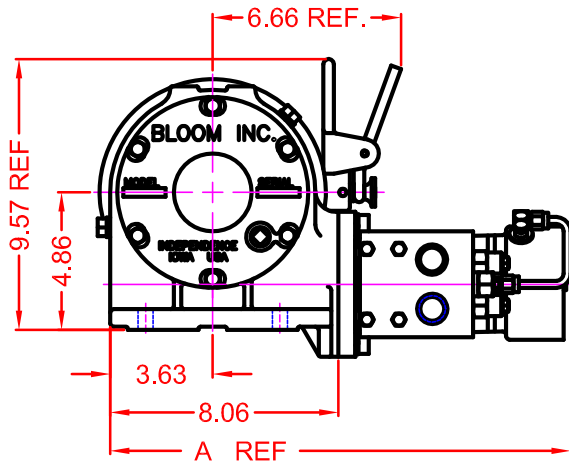

|                   |       |       |       |
|-------------------|-------|-------|-------|
| MOTOR DESIGNATION | 3.0   | 6.2   | 9.6   |
| A DIMENSION       | 15.91 | 16.28 | 16.53 |

| DRUM DESIGNATION | WINCH DIMENSION |   |       |       |       |      |       |
|------------------|-----------------|---|-------|-------|-------|------|-------|
|                  | C               | D | E     | F     | G     | I    | J     |
| S8               | 8               | 4 | 7.19  | 8.69  | 17.98 | 6.69 | 15.86 |
| L8               | 8               | 4 | 10.19 | 11.69 | 20.98 | 9.69 | 18.86 |



# Dimensional Drawings

1000H Series With XL10, XL12 & XL14 Drum  
Base Mount Model - Clutch Drive

“Quality Since  
1910”

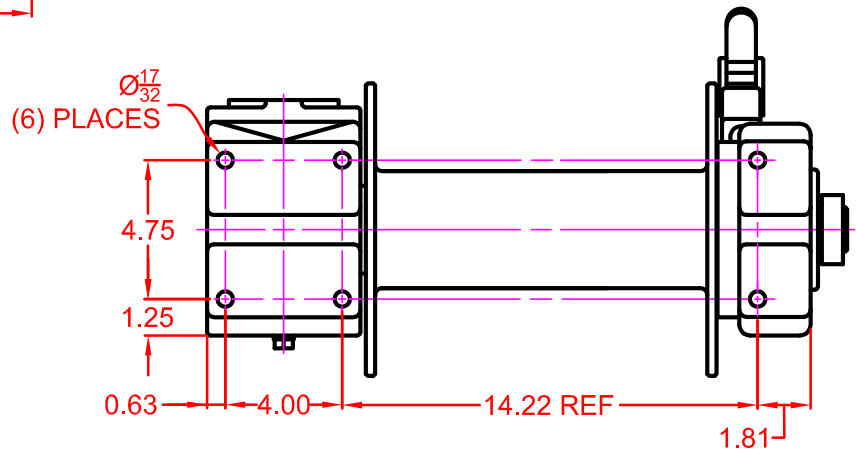
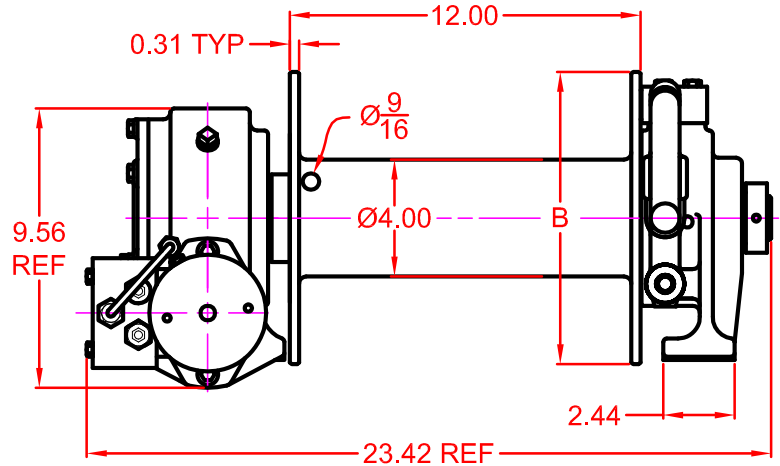
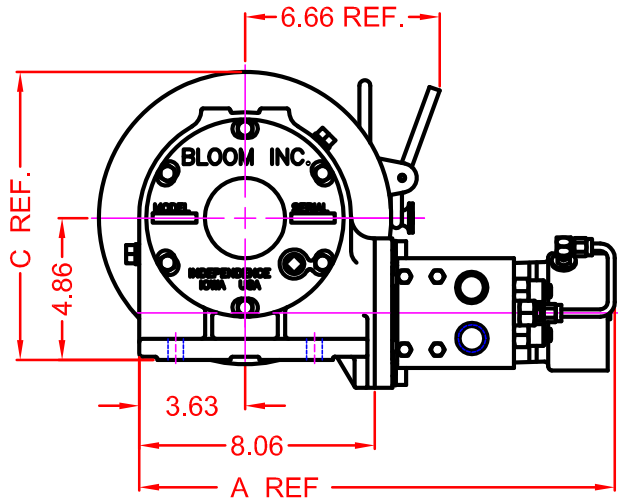

|                   |       |       |       |
|-------------------|-------|-------|-------|
| MOTOR DESIGNATION | 3.0   | 6.2   | 9.6   |
| A DIMENSION       | 15.91 | 16.28 | 16.53 |

|                  |      |       |       |
|------------------|------|-------|-------|
| DRUM DESIGNATION | XL10 | XL12  | XL14  |
| B DIMENSION      | 10   | 12    | 14    |
| C DIMENSION      | 9.86 | 10.86 | 11.86 |

## Correct choice of Directional Control Valves for Bloom Winches

**Motor Spool Valve** – Work Ports are **open** to tank in neutral position

Use on all winches that use Counter Balance Valves to hold load.

Some winches may use a combination of CB Valve and Hydraulic Brake.

\*Winches require ridged mounting plate.

See owner's manual for information about proper mounting plate thickness or call Bloom Sales Engineer at factory.

### **WARNING!**

Goods are not intended for use in the moving or lifting of persons!

The winches described herein are neither designed nor intended for use or application to equipment used in the lifting or moving of persons and it is understood that all such use shall be at the sole risk of the user.

The cable clamps on winches are not designed to hold rated loads. A minimum of 5 wraps of cable must be left on drum barrel to guarantee holding of rated load.

Applications of winch where life would be endangered by any event are not recommended.



# **BLOOM Manufacturing Inc.**

## **Winch Division**

1443 220<sup>th</sup> Street, Independence, Iowa 50644

FAX 319-827-1140 PHONE 319-827-1139

[www.bloommfg.com](http://www.bloommfg.com)